

Alpha SafeNet Portable Overwatch Device

Devices that Help Prevent Safety Zone Intrusions



**TRAFFIC SAFETY
SUPPLY COMPANY**



PRODUCT OVERVIEW

The Alpha SafeNet Portable Overwatch Device configuration is deployed on the roadside at the time of a traffic disruption. When activated, the system will create a straight, invisible, electronic barrier, thus protecting the work zone or traffic incident scene. If this barrier is crossed by a distracted driver, the Overwatch technology will sound a rear-facing horn alarm. If heeded, the driver can self-correct and the horn will discontinue. Personnel at the scene will also be alerted of the driving transgression and may quickly take action to escape the danger.

FEATURES AND BENEFITS

- Suitable for a variety of safety applications and deployments
- Utilizes LiDAR laser technology
- Head removable and stores in unit
- Sound assembly fully onboard & self-contained within the case
- Portable & convenient wheels/handle
- Built-in flashing warning lights - custom color configurations available.
- 20+ hr onboard, rechargeable battery
- Only 35 pounds portable
- Audibly alert the distracted driver
- Audibly alert the site personnel
- Discontinues alarm after correction
- Weather resistant for outdoor use
- Manual targeting in daylight and dark
- Effective 370+ feet in most conditions
- Smart Capable Waze® (optional)

Alpha SafeNet Portable Overwatch Device

Devices that Help Prevent Safety Zone Intrusions



TRAFFIC SAFETY
SUPPLY COMPANY

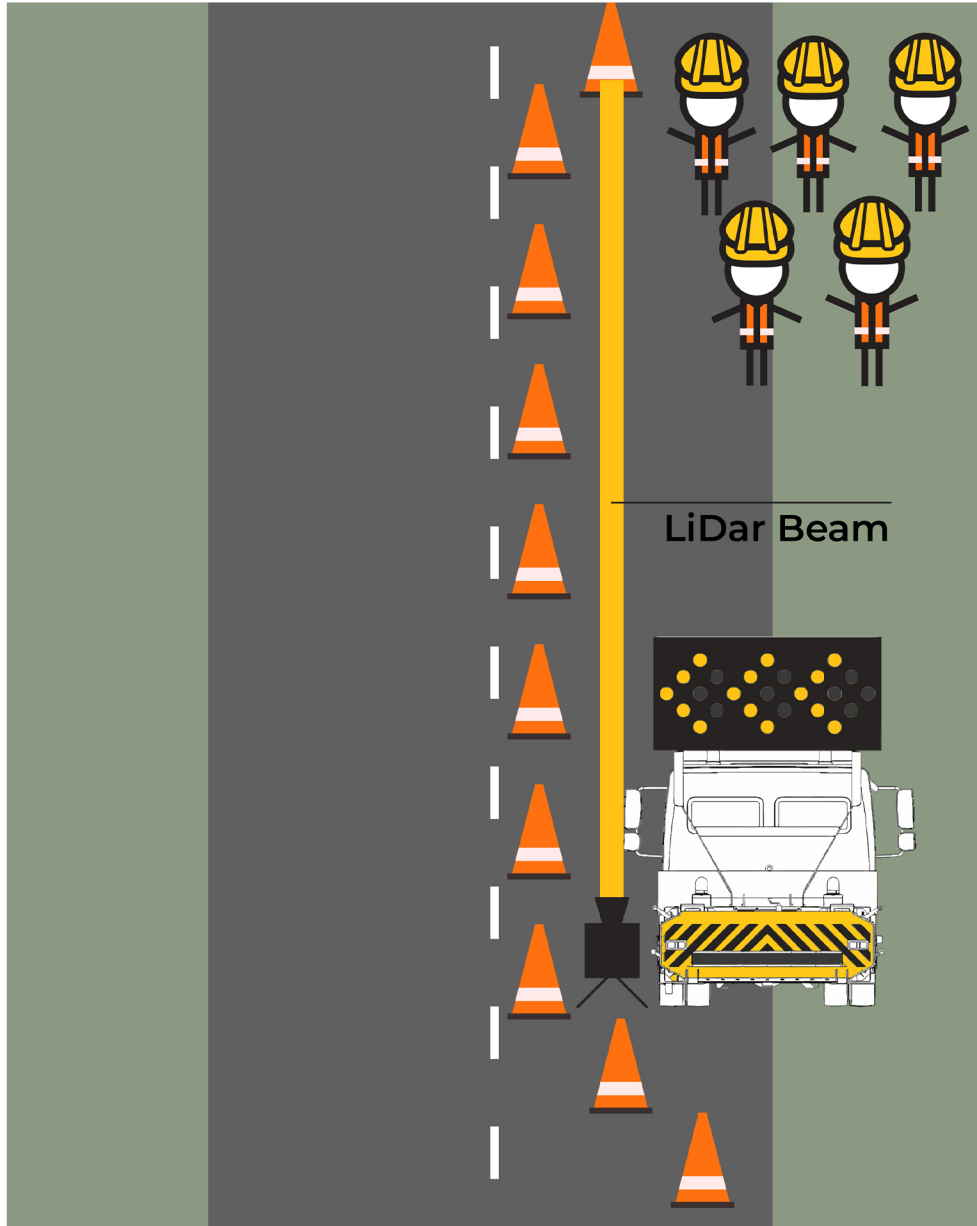

HOW IT WORKS

The Alpha SafeNet is set up on the border of the work site. If the laser is touched by a distracted driver crossing into the worksite, a very loud horn is deployed. This audible sound will alert not only the driver but the workers onsite. This will allow time for both the driver to correct their action and to alert the workers that someone has breached their worksite area.