

Rhino PD-55 Air Operated Post Driver



**TRAFFIC SAFETY
SUPPLY COMPANY**

PNEUMATIC POST DRIVER

The choice of professional installers for over 20 years, the Rhino PD-55 Pneumatic Post Driver is suited for driving t-posts, round rod, tent stakes, grape stakes, delineator posts, form pin and fence posts up to 3 5/8".

- One moving part, a double valve, reciprocating piston, insures low-maintenance and longevity.
- Only 54 pounds with an exclusive Alloy Steel, 3-1/2" piston, delivering up to 1700 blows per minute.
- Fits into tight jobsites, and only needs one operator.
- Additional driving options possible with easy bolt-on adapters.



070592
3 7/8 in (98.4)
Master Chuck
included with
driver.

Bolt-on adapters sold separately.

SPECIFICATIONS

PD-55

Duty	Medium
Air Consumption (CFM@90 psi)	42
Wt. lb (kg)	54.6 (24.8)
Ship Wt. lb (kg)	60 (27.2)
Master Chuck	3-7/8" ID

APPLICATIONS

3/4" to 1" Ground Rod	X•
3/4" to 1-1/2" Reinforcing Bat Tent Stakes	X•
1" Concrete Form Pins	X•
1" Pipe	X•
1-1/4" to 1-1/2" Pipe	X•
1-5/8" Pipe	X•
2" Pipe	X•
2-1/2" Pipe	X•
3" Pipe	X▼
T Posts	X•
Telespar Posts	X•▼
Telespar Post Breakaway Anchor 2-1/2"	X•◆
Telespar Post Breakaway Anchor 3"	X•◆
1.2 to 1.5 lbs/ft Channel Posts	X•
2 to 2.75 lbs/ft Channel Posts	X•
3 to 4 lbs/ft Channel Posts	X•
Channel Post Breakaway Anchor	X•◆
C Posts	X
Rectangular Posts	X
Fiberglass T Posts	X•

**Note: Specifications are approximate and subject to change.
Some parts shown may be for illustration purposes only.**

■ An optional master chuck is required ◆ A driving cap is required
• An adapter is required ▼ Indicates a combination of accessories is required

Rhino PD-55 Air Operated Post Driver



**TRAFFIC SAFETY
SUPPLY COMPANY**

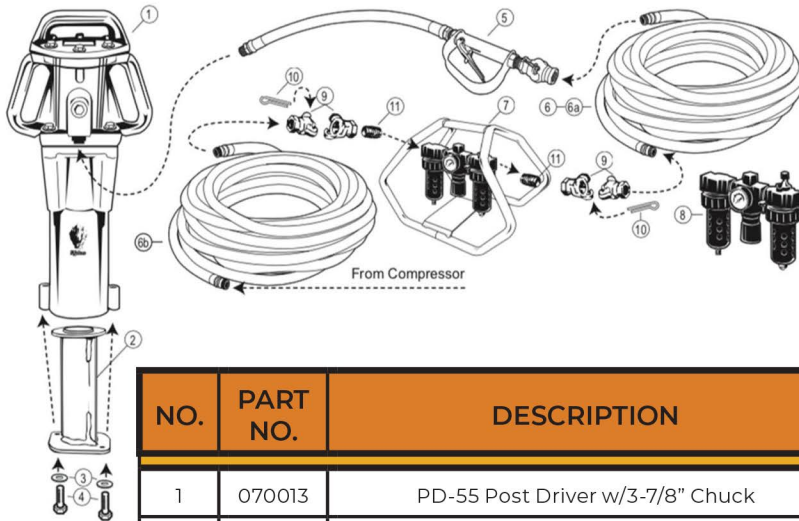

NO.	PART NO.	DESCRIPTION
1	070013	PD-55 Post Driver w/3-7/8" Chuck
2	070609	3-1/2" Chuck Adapter (see Chart 1 for more adapter options)
3	517702	Compression Washers (Qty. 2)
4	500007	Cap Screws (Qty. 2)
5	600000	Throttle Valve Kit with 5ft. Hose
6	607000	Hose Assembly*
	225005	Filter-Regulator-Lubricator (FRL) and carrier
7	225001	Carrier for FRL (FRL not included)
8	606600	Filter-Regulator-Lubricator (carrier not included)
9	606600	Air Line Coupler (pair)
10	606601	Coupler Safety Clip (limit 4 per order)
11	230401	Nipple

Made to order at desired length - additional charge per foot of hose

Chuck adapters and part numbers. 2.5", 3", and 3.5" Drive Cap Required for driving 2.5", 3" and 3.5" Schedule 40 Pipe. See Chart 1 for size information.



Note: Specifications are approximate and subject to change. Some parts shown may be for illustration purposes only.



PD-55 shown with FRL and Carrier

Chart 1 Master chuck and chuck adapter sizes and part numbers.

PD-66 ADAPTERS*/DRIVE CAPS	
DESCRIPTION/ACTUAL CAPS IN (MM)	PART NO.
3 7/8" (98.4) Master Chuck	070592
rs4-1/4" (107.9) Optional Master Chuck (uses PD-110 adapte)	070060
4-1/16" (103.2) Square Wood Post Chuck	070590
3-1/2" (88.9)	070609
3" (76.2)	070610
2-1/2" (63.5)	070611
2" (50.8)	070612
1-1/2" (38.1)	070613
1" (25.4)	070614
2" (50.8) Heavy for T-Post	070615
1 to 1.5 lb Channel	070617
2 to 2.75 lb Channel	070618
3 to 4 lb Channel	070619
2-1/2" Drive Cap, T-bar and Clip	070261
3" Drive Cap, T-bar and Clip	070262
3-1/2" Drive Cap, T-bar and Clip	070263

*All adapters come with required hardware